

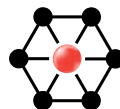

MUROX

BUILDING SYSTEM



CANAM
BUILDINGS

A SYSTEM ADAPTED TO YOUR NEEDS

Since 1978, Canam-Buildings has been designing and manufacturing the Murox® building system, one of the fastest construction solutions on the market for commercial, industrial and institutional buildings.

The Murox building system consists of prefabricated steel wall panels and is a flexible solution that adapts to your growth by allowing you to plan for future expansions and reuse the existing components of your building.

The Murox building system is integral to Canam's BuildMaster™ approach that redefines how buildings are designed and constructed. BuildMaster is a safer, faster and collaborative approach saving you significant time on the erection of the building structure.



A SYSTEM WITH MULTIPLE ADVANTAGES

Load-bearing walls	All interior space is usable by integrating exterior columns and vertical bracing into the Murox panel.
Speed	Allows other sub-trades to access the job site faster, reducing the construction schedule and costs.
Quality	Shop-manufactured under controlled conditions.
Technical expertise	Building heights up to 115 ft. Clear spans up to 205 ft. In house engineering capabilities for steel and foundation design.
Flexibility	Easy to expand; panels can be reused on future expansions.
Sustainability	Contributes to LEED certification. The only system to offer integrated solar thermal wall panels (VTP). Substantially reduces the amount of material waste on the job site. Thermal resistance meets or exceeds latest energy codes.
Services	Coordination of all the engineering and construction aspects of the structure and building envelope allows owners, contractors and consultants to focus their attention on other critical phases of the project.
Maintenance	Ideal for dust-laden building environments. By incorporating girts and bracing in the wall panel design, dust accumulation is eliminated.

THE MUROX SYSTEM

The use of Murox load-bearing wall panels makes it possible to eliminate columns around the building perimeter as well as the vertical bracing in the interior of the building. This increases the flexibility of the interior space. The panels are shop-fabricated in accordance with strict quality standards, and Canam's quality assurance program, which is based on ISO 9001:2000 and CSA A660-10.

The Murox building system includes the building envelope, steel structural components and can include doors and windows. Depending on the requirements of your project, Murox wall panels can also be non-load-bearing, while providing all the same benefits.

Cost-effective performance

The wall panel design is backed up with multiple performance test certifications and complies with the latest building and energy codes. This provides major savings to the tenant throughout the lifecycle of the building.



Certifications

Assembly quality	ISO 9001:2000
Manufacturer of steel building systems	CSA A660-10
Fire resistance	1 hour resistance: UL/ULC W011 and U048
Acoustical properties	STC 38 (minimum) as per ASTM E90
Air infiltration	A1 classification: CAN/ULC-5742-11 and ASTM E2357-11
Thermal resistance	Thermal resistance of R-20 (minimum) certified by an independent laboratory as per ASTM C1363-11
Rain screen	Meets Rainscreen principles

* See the Murox product data sheet for more information.

THE MUROX SYSTEM

Fire-resistant walls

Murox panels are also available with one-hour fire resistance, certified by UL and ULC.



Underwriters Laboratories of Canada
www.ulc.ca



Underwriters Laboratories Inc.®
www.ul.com

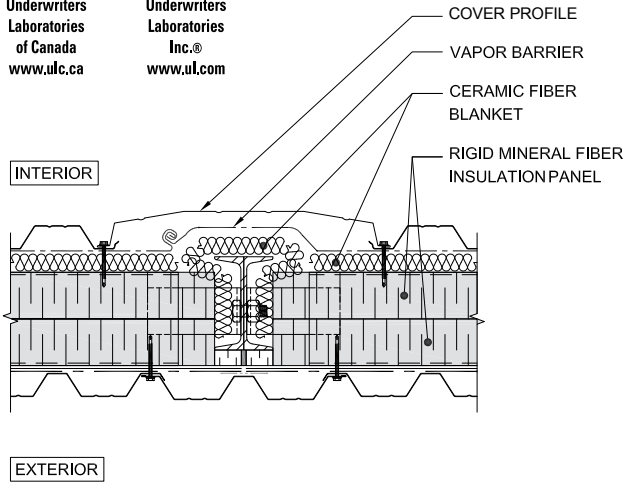

Ventilated thermal panels

Ventilated thermal panels (VTPs) are an efficient and cost-effective solution for buildings that require frequent air exchange. Heating fresh air as it enters the building reduces energy costs by up to 25%. The VTP is incorporated in the Murox load-bearing wall panel and is entirely shop-assembled to ensure quick on-site installation. The depth of the VTP is similar to that of the load-bearing wall so it does not detract from the aesthetic design of the building.



Overhead crane supports

Murox panels offer advantages for buildings that require overhead cranes. Canam's technical team will guide you to the best solution to support the overhead crane that you have selected.



Top-running crane – Type 1



Top-running crane – Type 2



Underhung crane

SIMPLIFIED SITE MANAGEMENT AND **FAST-TRACK CONSTRUCTION**

The efficiency of the Murox building system becomes apparent from the design stage. After analyzing the customer's needs and building layout, Canam's technical team will optimize the design of the structural components.

Canam works closely with its customers and partners to make the building construction process simple and predictable, and to meet the construction schedule.

Typical steps for the installation of a 55,000 sq. ft. warehouse:



At the plant

While the foundations are being installed at the job site, the Canam team is already at work in the plant, manufacturing the system components under ideal conditions. Personnel doors and windows are installed at the plant.



Start of construction

Murox building system components are delivered to the job site.



Simultaneous installation of the structural steel components and the wall panels begins.



Construction in progress

Installation of the steel deck begins even as wall panels and structural steel are being erected.



Erection of the steel structure and wall panels is completed. Once the steel deck is installed, the other sub-trades can start working.



End of construction

Now that the building shell is virtually completed, the other sub-trades can access the job site while Canam carries out its finishing operations.

ARCHITECTURAL FLEXIBILITY WITH A **MULTITUDE OF POSSIBILITIES**

Whether it's for a warehouse, a shopping mall or an institutional building, developers and consultants enjoy a high degree of architectural flexibility, thanks to the wide range of finishes available and the customized structural layouts offered by the Murox building system.

Metal cladding

Metal cladding is an economical solution, both inside and outside your building. Canam offers multiple steel profiles in a variety of colors that can be installed both vertically and horizontally. This type of cladding can easily be replaced while the building is in use. See the Murox Cladding Products brochure for more information.

Unfinished wall panels

Murox building system wall panels are also available unfinished on exterior-grade gypsum board, ready for any other choice of finish.

Insulated metal panels

Canam can offer a wide range of insulated metal panels for various building types including cold storage facilities, ice arenas or food-processing plants. Available in a variety of R-values, they can be used in combination with other finishes.

Canopies

To complete your Murox building, Canam customers can choose from a range of canopy models. Canam's canopies are available in a wide range of colors.



QUALITY EVERY STEP OF THE WAY

Great care is taken at each step of the process, from design to manufacturing, delivery to installation, to ensure that your building is constructed to the highest standard.

- Coordination of all technical and engineering aspects, starting from the design stage.
- Use of materials that meet superior quality standards.
- Shop-fabrication of wall panels under controlled conditions.
- Factory-installation of personnel doors, windows and other accessories.
- Field supervision of the building installation to ensure integrity of the building envelope.
- All Murox buildings are designed, delivered and installed with Canam's BuildMaster collaborative approach to ensure safety and commitment to schedule and budget.





BUILD **DIFFERENTLY**

For more than 50 years, Canam has developed a fast, reliable construction method that adapts to all your commercial, industrial, institutional or multi-residential projects. Whether you are building structures, floors, walls or steel building envelopes, our construction solutions are simple and straightforward. No surprises.



CANAM
BUILDINGS

1-866-466-8769

canam-construction.com/murox

BuildMaster, Canam and Murox as well as all logos identifying the activities of Canam Group Inc. and its subsidiaries are trademark of Canam Group Inc. and its subsidiaries.

© Canam Group Inc., 2007-2015
Last modified on 11/2015
Printed in Canada